

Produkt zu ersetzen :

Nicht identifiziertes Schloss

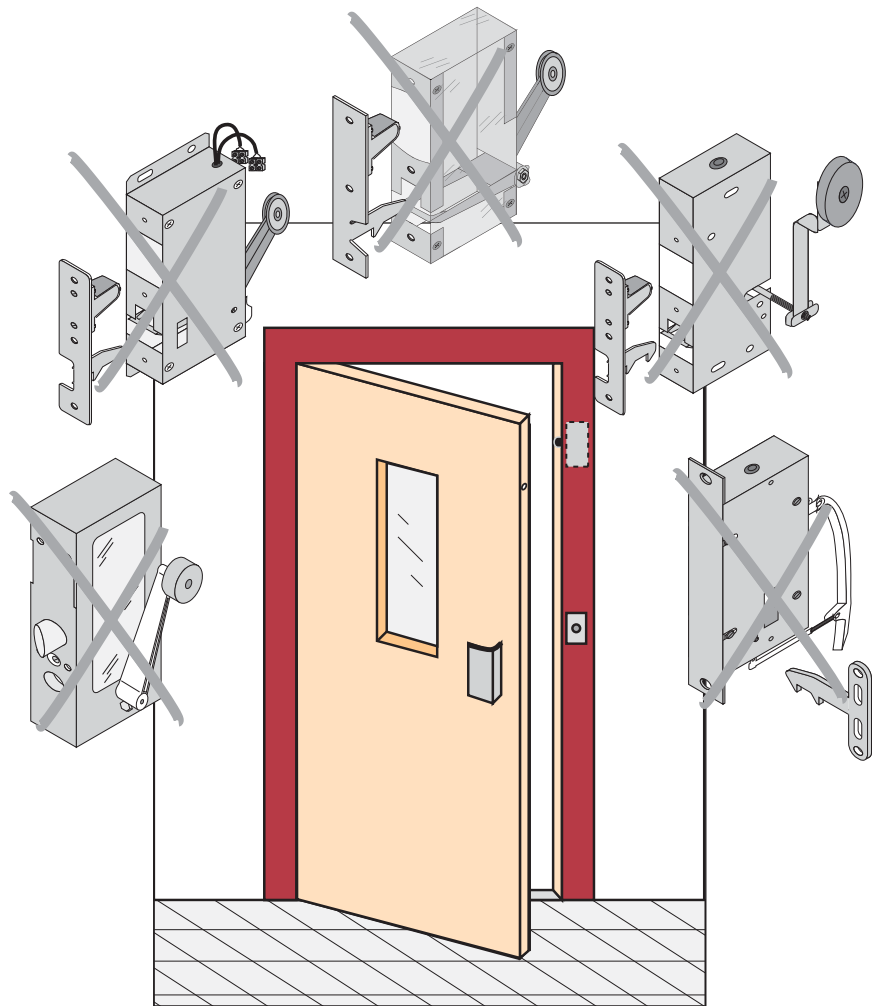

Ersatzprodukt :

SPX4-Ex/*D (recht) (prudhomme S.a.)

SPX4-Ex/*G (links)

Option :
CP/SPX4/Ex (Bohrkaliber)
CP/DV/SPX4/Ex (Bohrkaliber)

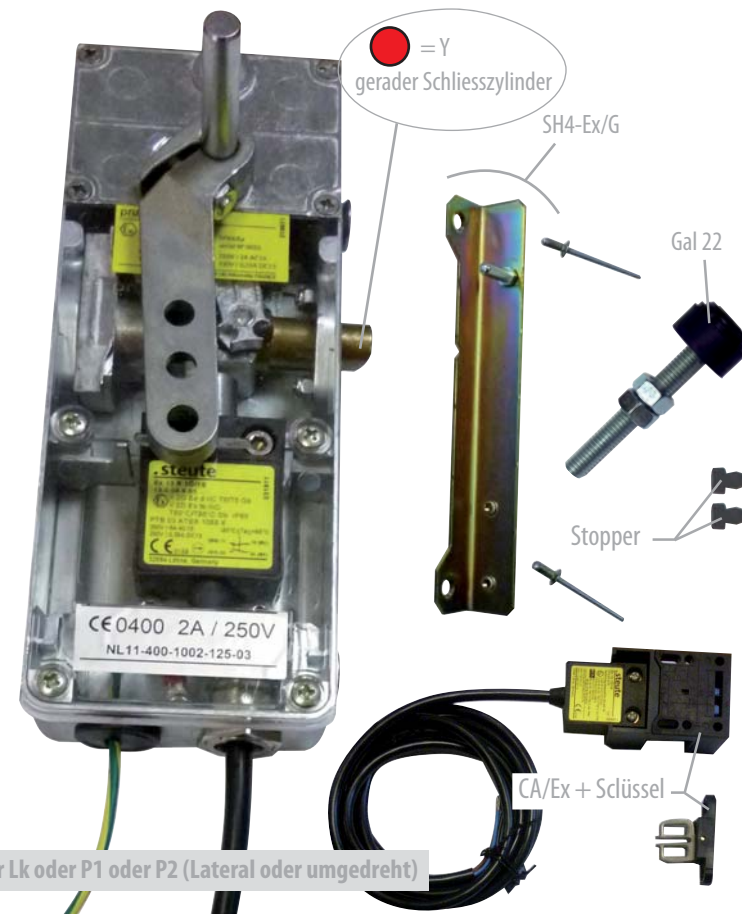

* = L oder Lk oder P1 oder P2 (Lateral oder umgedreht)

Schloss SPX4 für Schwingtür für Atex

SPX4-Ex

réf. : SPX4-Ex/*G

réf. : SPX4-Ex/*D

* = L oder Lk oder P1 oder P2 (Lateral oder umgedreht)

Links

| | | | |
|------------------------|-----------|------------------------|------------------------|
| * = L _k | * = L | * = L ₁ | * = P ₁ |
| * = P ₂ | * = C | * = E | |

Rechts

| | | | |
|------------------------|-----------|------------------------|------------------------|
| * = L _k | * = L | * = L ₁ | * = P ₁ |
| * = P ₂ | * = C | * = E | |

+

SH4-Ex/G (links)

Stopper

+

SH4-Ex/D (rechts)

Stopper

Montage-Phasen :

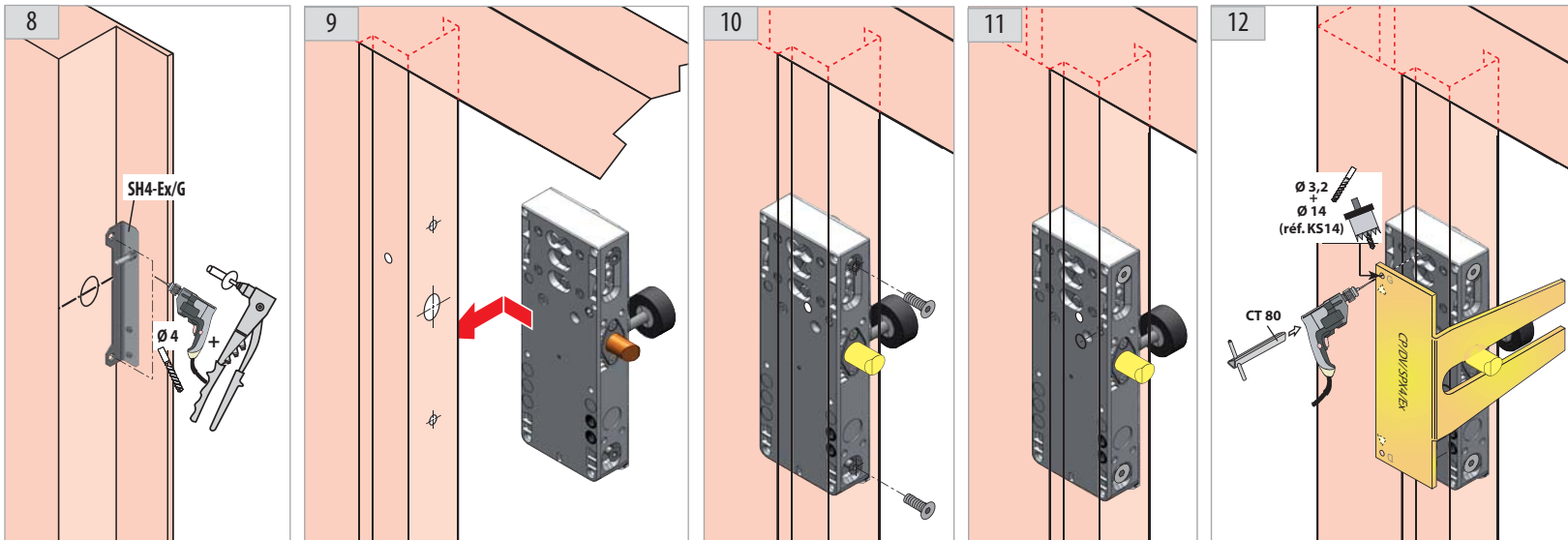
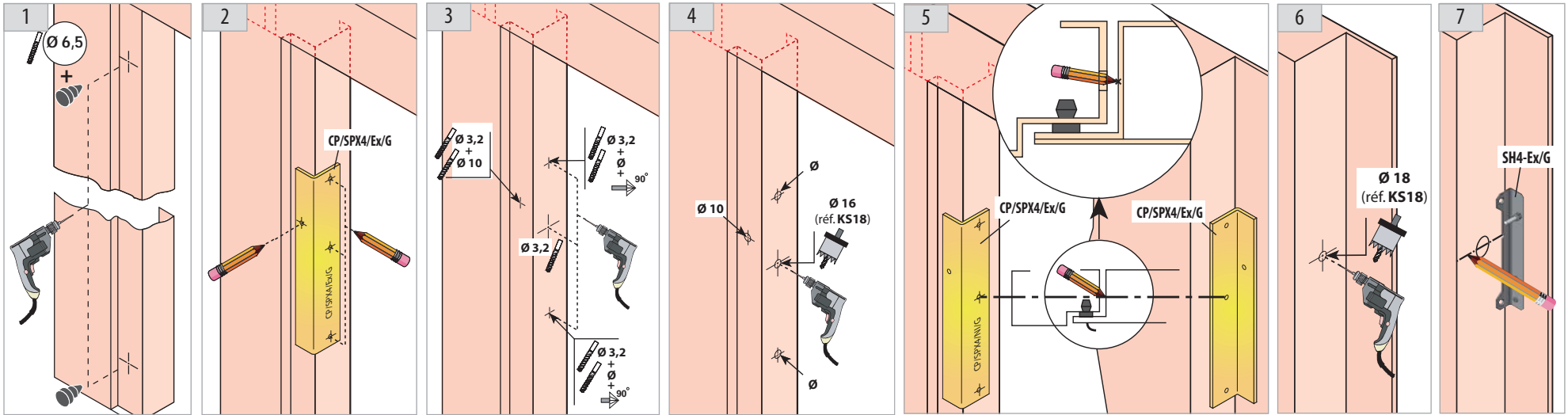
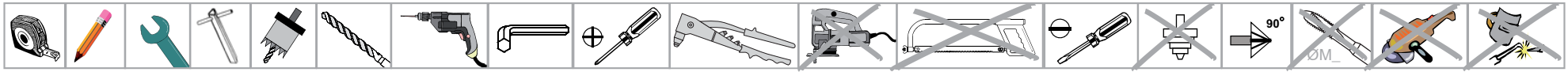

Information

